

Multiblindo Easy - Easy EXIT

Self-locking
mechanical lock



PRODUCT

Mechanical and self-locking lock, suitable for doors with different locking points and with a high level of security (the highest grade according to reference standards). Multipoint versions for door heights up to 2300 mm and in combined with extension with 4°/5° locking points for doors up to 3220 mm in height. Also available in panic version: Multiblindo Easy EXIT.

APPLICATIONS

Multiblindo Easy and Easy EXIT locks are recommended to securing the following entrances:

- Banks panic exit routes
- Jewellers entrances
- Post and public offices entrances and panic exit routes
- Legal offices entrances
- Laboratories facilities entrances
- Shopping centres entrances and panic exit routes

ISEO[®]
ULTIMATE ACCESS TECHNOLOGIES

TECHNICAL FEATURES

Centre distances	92 mm (94 mm with swiss cylinder)
Backsets	35-40-45-50-55-60-65 mm
Handle Followers	8 mm Easy 9 mm Easy EXIT (panic/escape routes)
Front plates	Lateral locks with sections: <ul style="list-style-type: none">■ U 24x6 in stainless steel for aluminium doors■ Flat 24x3 in stainless steel for aluminium/iron doors Multipoint locks with adjustable height leaves starting from 2300 mm or fixed lengths at 1860 mm with sections: <ul style="list-style-type: none">■ U 24x6 in stainless steel for aluminium doors■ Flat 24x3 in stainless steel for aluminium/iron doors Extension with 4°/5° point of closure, adjustable height up to 3220 mm with sections: <ul style="list-style-type: none">■ U 24x6 in stainless steel for aluminium/iron doors■ Flat 24x3 in stainless steel for aluminium/iron doors

Interchangeable with Classic

Microswitch to signal open/closed position of the deadbolts for Easy EXIT (panic lock)

Fixed latch, with right/left hand, with an increased distance from the trigger, for automatic deadbolt locking

- | | |
|-----------|--|
| Lock case | <ul style="list-style-type: none">■ Equipped with through screw holes for easily fixing the handle■ Closed on all sides to prevent that bars from machining can jam in the lock mechanisms and to make an high resistance of the door to a possible burglary attempted from the back of the lock case |
|-----------|--|

Possibility to match Multiblindo with ISEO cylinders to allow resistance to external attacks, reliability, durability and protection against attempts of unauthorized key duplication.

The trigger of the automatism must work within a range of 4 mm for correct operation of the lock. The measurement depends on the type of faceplate and counterplate, please carefully consult the instructions

Multiblindo Easy - Easy EXIT

Self-locking
mechanical lock

OPERATION

- Both locks are self-locking: by closing the leaf, the lock engages the deadbolts automatically.
- The locks are equipped with three options of reclosing, which can be easily set at any time according to the daily use and requirements through a special mechanical selector placed on the front plate:
 - 0-total** deadlock with deadbolts and latch completely and self-locking engaged
 - 1-light** partial reclosing with only the latch, to be used in high traffic conditions
 - 2-free** no re-locking, to leave the door always unlocked.
- From the inside, it is possible to exit by disengaging the latch and deadbolts by operating a handle (in the case of the Multiblindo Easy) or the panic bar or handle emergency handle (in the case of the Multiblindo Easy EXIT).
- From the outside it is a prerequisite the use of a knob or a fixed handle and the entrance is allowed only by using the key.
- The key disengages the deadbolts and the latch. In the Easy version, by operating one key the inside handle rotation can be locked.

RANGE

- Lateral EXIT self-locking mechanical lock with panic or emergency device
- Multipoint self-locking mechanical lock
- Multipoint EXIT self-locking mechanical lock with panic or emergency device
- Multipoint self-locking mechanical lock + Extension
- Multipoint EXIT self-locking mechanical lock + Extension with panic or emergency device



LATERAL BLINDO EXIT for emergency or panic device

MULTIPOINT

MULTIPOINT EXIT for emergency or panic device

MULTIPOINT + second leaf semi-fixed with espagnolette

MULTIPOINT EXIT for emergency or panic device + second leaf semi-fixed with espagnolette

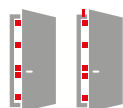

MULTIPOINT with extension



MULTIPOINT EXIT with extension for emergency or panic device

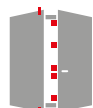

MULTIPOINT with extension + second leaf semi-fixed with espagnolette



MULTIPOINT EXIT with extension for emergency or panic device + second leaf semi-fixed with espagnolette

ISEO[®]
ULTIMATE ACCESS TECHNOLOGIES

MAIN ACCESSORIES AND MATCHING PRODUCTS

- Aries electronic handle
- MA1A Connected Smart Handle
- Libra Smart electronic cylinder
- CSF F9000 mechatronic cylinder
- PRO EXIT panic bar combined with Easy EXIT is certified EN1125 for panic doors
- Dorma PLUS and Premium handles, series 810** to be combined with Easy EXIT certified for emergency door according to EN179
- Adjustable or fixed strike plates in stainless steel
- Mechanical strike plates
- Adjustable stainless steel long strike plates
- Adjustable stainless steel long strike plates for two-leaf door with semi-fixed second leaf. The strike plate is equipped with a manually operated lever espagnolette

STANDARDS

Lateral EXIT:

- EN12209 (grade 7) classification: I3IXI9IBI0IGI7I0I
- CE EN179 classification: I3I7I7IBI1I4I5I2IAIBI
- CE EN1125 classification: I3I7I7IBI1I4I2I1IAIBI

Multipoint:

- pr EN15685 (grade 7) classification: I3IXI9IBI0IGI7I0I3I0I
- VDS Class C

Multipoint EXIT:

- pr EN15685 (grade 7) classification: I3IXI9IBI0IGI7I0I3I0I
- CE EN179 classification: I3I7I7IBI1I4I5I2IAIBI
- CE EN1125 classification: I3I7I7IBI1I4I2I1IAIBI
- VDS Classe C

Multipoint + Extension (4°/5° point of closure):

- pr EN15685 (grade 7) classification: I3IXI6IAI0IFI7I0I3I0I

Multipoint EXIT + Extension (4° point of closure):

- pr EN15685 (grade 7) classification: I3IXI6IAI0IFI0I7I3I0I
- CE EN179 classification: I3IXI6IAI0IFI7I0I3I0I
- CE EN1125 classification: I3I7I7IAI1I3I2I2IAIAIBI

TEXT FOR SPECIFICATIONS

Multiblindo Easy is a high security multipoint self-locking lock certified according to pr EN15685. Multiblindo Easy EXIT in its lateral and multipoint automatic version are respectively certified according to the EN179 and EN1125 for panic exit route doors. Multipoint version is VDS class C Certified.

Multiblindo Easy - Easy EXIT

Self-locking
mechanical lock

HIGHLIGHTS

- High resistant locks, certified according to the maximum levels (grade 7) of the following reference standards EN12209, pr EN15685:
 - resistance to lateral and bottom forcing with a load of over 1000 kg;
 - resistance to a front load of over 600 kg.
- **Durability:** tested to over 200.000 opening and closing cycles under a load of 120 N on the door.
- A specific high performance patented system allows the operation of the bolts only when the latch is engaged in the strike plate by at least 3 mm: in this way, the door is perfectly aligned, ensuring a longer service life.
- **Deadbolts with independent resistance at burglary:** each deadbolt is designed to offer its own resistance to break-in attempts. This feature allows, in the event of burglary attempt on one deadbolt, that the others continue to resist independently. The attack must be repeated for each individual locking point.
- **Reinforced deadbolts:** the deadbolts of are reinforced through hardened steel plates on both sides, this material gives greater resistance to cutting and drilling. The deadbolts can be swinging or hook type with anti-lift pin: both models provide better locking and resistance of the door to burglary.
- On the Easy version, it is possible to exclude the inside handle rotation through an additional key throw when the deadbolts are engaged. This prevents unauthorized intrusion through breaking of the door glass (security) a greater control over the exit.
- Extensions that can be combined with Multiblindo Easy and Easy EXIT for doors up to 3220 mm with 4°/5° locking points.

Multiblindo Easy - Easy EXIT

Self-locking
mechanical lock

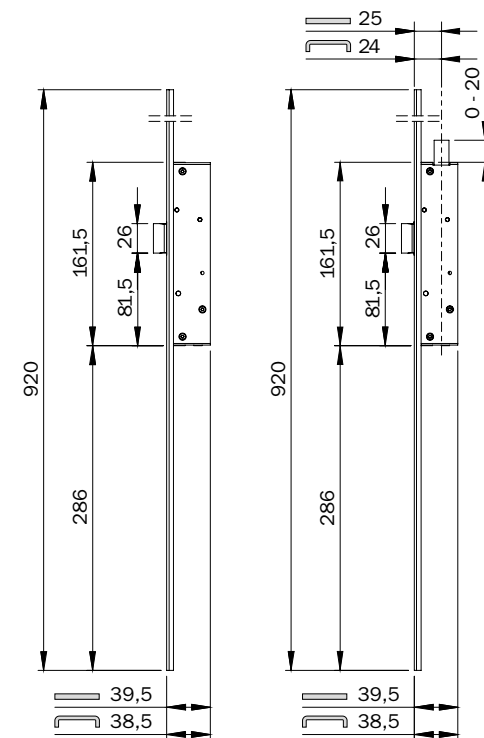
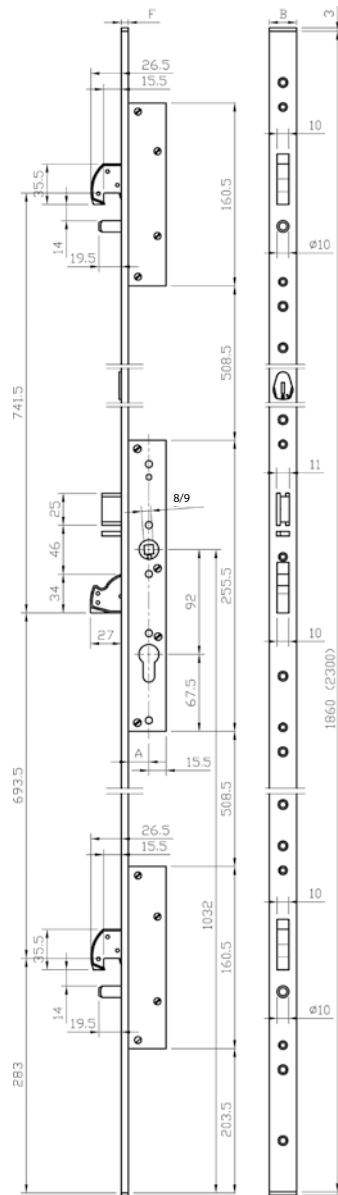

Multipoint

Extension

Multiblindo Easy - Easy EXIT

Self-locking
mechanical lock

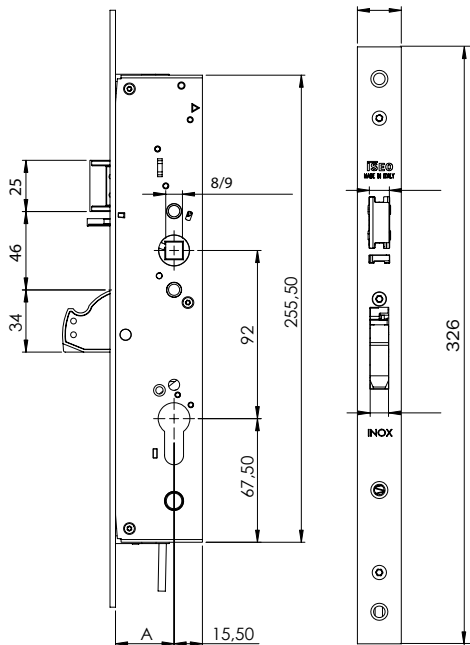

Lateral EXIT

